

Division Chief, Pediatric Pulmonology

The University of Arkansas for Medical Sciences (UAMS) and Arkansas Children's Hospital and in Little Rock, Arkansas seek a full-time board-certified pulmonologist to lead a nationally recognized (USNWR currently #24) and academically productive pediatric pulmonary division.

The Opportunity:

- **Chief role comes with the James H. Hamlen II Endowed Chair in Pediatric Pulmonology**
- Competitive salary and benefits package along with a robust faculty mentoring program for promotion and/or tenure
- Strong team including eight pulmonologists, a sleep specialist, advanced practice/specialty nurses, pediatric Pulmonary Medicine fellows, respiratory therapists, social workers and nutrition specialists
- Pulmonary Clinics in Little Rock and AC Northwest, with more than 7,000 outpatient visits/year, specialty nurse support and full respiratory therapy support in all clinics
- State-of-the-art pediatric pulmonary diagnostic services, performing ~ 12,000 PFT/year as well as bronchoscopy, nasal nitric oxide and other specialized testing
- Inpatient pulmonary service, pulmonary consultation service and strong collaborative NICU consultation service, with weekly Pulmonary-Neonatology care conferences year-round
- A large, innovative home ventilator program, with more than 12 non-ICU inpatient beds designed for children with chronic ventilator needs, large outpatient population of respiratory technology-dependent children, and unique telehealth ventilator weaning program
- Member of the National Bronchopulmonary Dysplasia (BPD) Collaborative, with active participation in and co-leadership of several multi-center projects
- Strong research productivity, with 15 peer-reviewed publications from Pulmonary in FY22 and opportunities to expand
- Active involvement in educating medical students, residents and fellows with additional opportunity for leadership, educational outreach, as well as basic and clinical research
- Pediatric Pulmonology Fellowship, established in 2005, with three fellows and strong educational program
- Pulmonary specialists attend numerous multidisciplinary clinics, including the Severe Asthma Clinic, SMA Clinic, Muscular Dystrophy Clinic, Sickle Cell Clinic, Fontan Clinic, Pulmonary Hypertension Clinic and Aerodigestive Clinic. Opportunities for further clinical expansion
- State-wide childhood asthma program in partnership with Allergy/Immunology
- The only Cystic Fibrosis Center in the state, including active participation in the Cystic Fibrosis Foundation Therapeutics Development Network (TDN) for 12 years
- The only accredited Primary Ciliary Dyskinesia (PCD) center in the state
- The only accredited Pediatric Sleep Disorders Center in the state, with approximately 1,200 Pediatric Sleep Clinic outpatient visits/year and over 1,200 pediatric sleep studies/year. Currently planning expansion of sleep services and laboratory capacity

The University of Arkansas for Medical Sciences

The UAMS Department of Pediatrics is the largest department in the UAMS College of Medicine and includes more than 300 primary faculty in 25 sections and over 1,100 employees. Our 99 total residents are complemented by our 61 fellows. Our Office of Education also oversees 12 current pediatric fellowships, including one of only nine pediatric clinical informatics fellowships, and we are increasing to approximately 20 pediatric fellowships during the next three years.



Arkansas Children's Hospital

As one of the largest children's hospitals in the country, the ACH campus spans 36 city blocks and includes a 336-bed hospital, three intensive care units, a research institute, and a USDA-ARS nutrition center. Staff consists of more than 500 faculty, 200 residents (99 pediatrics), and 4,400 support staff. ACH is a MAGNET recognized hospital, a level 1 children's surgery center, and is ranked in seven specialties by *US News and World Report*.

Little Rock, Arkansas

Little Rock has a metropolitan area population of approximately 500,000 and is centrally located and has amazing scenery, museums and cultural events, parks, gourmet dining, and a vibrant nightlife. Little Rock also offers affordable housing in great neighborhoods and low cost of living. The city is large enough to be culturally diverse and small enough to encourage a feeling of community. The state of Arkansas as a whole is a true natural wonder and offers no shortage of outdoor recreation destinations — 52 state parks, lakes, rivers, world-class mountain biking trails, and so much more.



Contact:

Meghan Baser, Physician Recruiter
Office 501-364-3675 BaserMeghanC@uams.edu
uams.edu archildrens.org

UAMS is an Affirmative Action and Equal Opportunity Employer of individuals with disabilities and protected veterans.

The University of Arkansas for Medical Sciences

Department of Pediatrics



"There has never been a more exciting time to be in pediatrics—modern medicine is changing at lightning speed, offering innovative ways to discover, learn, and practice. This is a time of exceptional growth and energy at the UAMS Department of Pediatrics and Arkansas Children's, with excellence in cutting-edge clinical care, innovative discovery of tomorrow's cures, advocating for all children, and teaching the next generation of providers."

William J. Steinbach, M.D.

Robert H. Fiser, Jr., M.D. Endowed Chair in
Pediatrics Chair, Department of Pediatrics
Associate Dean for Child Health
Pediatrician-in-Chief, Arkansas Children's

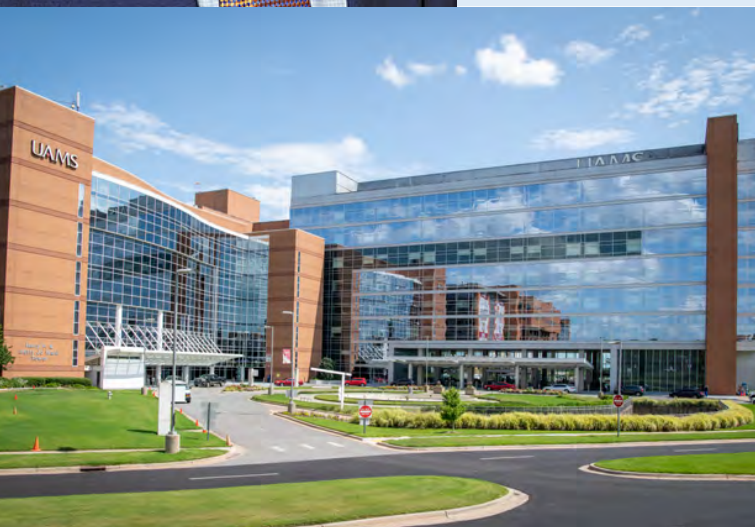

**Arkansas
Children's**

HOSPITALS • RESEARCH • FOUNDATION



We are National Leaders in Pediatric Care, Research, Education, and Advocacy

The Department of Pediatrics is the largest department in the University of Arkansas for Medical Sciences' College of Medicine. It supports the Arkansas Children's system, including Arkansas Children's Hospital (ACH), Arkansas Children's Northwest (ACNW) and Arkansas Children's Research Institute (ACRI). Our mission is to provide exceptional, family-centered care driven by scientific discovery and evidence-based medicine as we train the next generation of pediatricians and leaders in pediatric health.



The Department of Pediatrics has more than 300 primary faculty and 100 advanced practice providers organized in 25 sub-specialty sections. There are more than 500 physicians in the Arkansas Children's system, including 14 additional sections with numerous pediatric specialty surgeons, radiologists, anesthesiologists, and others.

We are an entire robust pediatric healthcare system with large contingents of pediatric sub-specialties, including one of a limited number of pediatric surgery fellowships in the country and a dedicated burn unit. We have multiple pediatric health programs that other children's hospitals do not possess due to our large size and reach in the state and region.

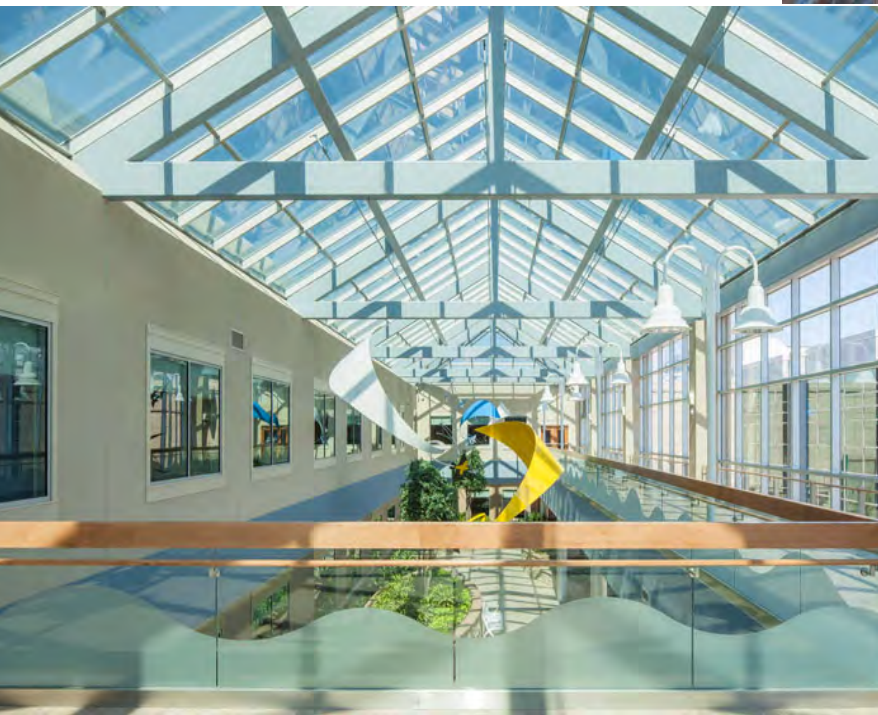

We have the **20th** largest pediatric residency program in the country, averaging **75** pediatric residents in postgraduate years 1-3, **two** pediatric neurology residents, **18** medicine-pediatric residents and three chief residents. We have an additional **61** fellows throughout numerous specialties.

Our Office of Education oversees **10** current pediatric fellowships, including one of only **nine** pediatric clinical informatics fellowships. This number will increase to approximately **20** pediatric fellowships over the next three years.

Working and training at Arkansas Children's provides fantastic opportunities to see a wide breadth of patients while having sufficient autonomy to make decisions and catapult your education.

Patient Care



Arkansas Children's Hospital was recognized in the *U.S. News & World Report's* National Rankings for excellence in seven pediatric sub-specialty services, placing us as one of the top children's hospitals in the nation

Our dedicated Little Rock pediatric medical campus spans **36 city blocks** and is anchored by a **336-bed** freestanding children's hospital. Our Emergency Department has **38 beds, 4 large trauma bays** and sees more than **60,000 patient visits** per year. Our Pediatric Intensive Care Unit has **26 beds**, the Cardiac Intensive Care Unit has **31 total monitored beds**, and our Level IV Neonatal Intensive Care Unit has **168 beds** divided between the Arkansas Children's and UAMS campuses. We have gorgeous, cutting-edge facilities, including brand-new catheterization (cath) labs, radiology technology, and more.



Patient Care

Arkansas Children's champions children by making them better today and healthier tomorrow. Arkansas Children's strives to accomplish its mission by offering **more than 80 specialty clinics and services**, all of them providing the very best in emergency medicine and acute care as well as preventative and well-childcare.



Patients and families are our primary focus, and we designed the hospital to support their healthcare journey. Parents and caregivers are essential sources of strength and support for the infants, children, adolescents and adults who receive care at Arkansas Children's Hospital. We developed our model of care with patients and their families in mind. Our physicians focus on compassion, respect, collaboration, support and advocacy for each patient and family member.

We work with our patients and families to create an empowered environment where evidence-based practices are implemented to assure safe, high-quality, comprehensive care.

From the design of our buildings to the doctors we hire, the needs of children and families are always our priority. We are 100% focused on highly-specialized children's care. Because of that, we know what patients and families need most to heal.

Our spaces were designed for family-centered care. They promote healing and well-being through:

- Wellness spaces designed to raise children's discovery and delight
- Outdoor gardens, nature trails and interactive features designed just for children
- Rooms for breast-feeding available throughout our locations



Patient Care



Our nationally-recognized Divisions cover multiple specialties and types of care.

The **Division of Pediatric Cardiology** cares for patients with conditions ranging from common to complex. The Division is home to many notable sub-specialties and programs, including **the state's only Single Ventricle Program**, a dedicated **3-D print lab** used to make plastic models of complex hearts, **state-of-the-art cardiac cath labs** and a **31-bed CVICU**.

Also among the sections recognized by USNWR, our **Division of Pediatric Hematology/Oncology** is the only childhood cancer treatment center in Arkansas. **The center provides care for more than 90% of the children in the state who have cancer.** The Hematology/Oncology Division also provides comprehensive care to kids with sickle cell diseases, bleeding and varied hemoglobin disorders.

Our **Division of Pediatric Endocrinology** operates an ADA-Certified diabetes program and is backed by a multidisciplinary team of Certified Diabetes Care and Education Specialists, dietitians, social workers, and nurse practitioners. The Division also provides world-class clinical care focused on patient needs and addressing the family's concerns through its **General Endocrinology Clinic**, **Diabetes Clinic**, the **Center for Obesity and Its Consequences on Health program (COACH)** and the **PATHWAY Clinic** for transgender youth.



Patient Care

The **Division of Pediatric Nephrology** is the state's only accredited pediatric dialysis unit that offers chronic peritoneal and hemodialysis in addition to being the only Centers for Medicare and Medicaid Services (CMS) certified pediatric kidney transplant program. The Division operates clinics at Arkansas Children's Hospital, Arkansas Children's Northwest and Arkansas Children's Jonesboro locations. In a given year, our clinics see more than **3600 outpatient appointments across the state** and perform **more than 500 24-hour ambulatory blood pressure measurement studies**. Our team also participates in several multidisciplinary clinics for children with complex genitourinary disorders, spina bifida, tuberous sclerosis complex, vasculitis and more.



The **8 jj [g]cb'cZDYXJuf]WDi`a cbc`c[** misubspecialists at Arkansas Children's provide comprehensive evaluation and treatment for children with conditions such as cystic fibrosis, chronic cough, asthma & other causes of wheezing, aspiration/dysphagia-related lung disease, chronic lung disease of prematurity (bronchopulmonary dysplasia), and a wide variety of other disorders.

The Arkansas Children's **Pediatric Sleep Disorders Center** is a full-service, nationally accredited Pediatric Sleep Medicine Center serving the entire state of Arkansas. The state-of-the-art five-bed pediatric sleep laboratory, located at Arkansas Children's Hospital in Little Rock, provides all types of sleep studies for the diagnosis of childhood sleep disorders as well as determining appropriate therapies such as CPAP and bi-level positive pressure.



The **8 jj [g]cb'cZDYXJuf]WBf] fc`c[** mitreats patient with all forms of neurological disorders, including epilepsy, neuromuscular disease, autoimmune disease, chronic headaches, movement disorders, spasticity, neurodevelopmental disabilities and more. **The Division is a Level IV National Association of Epilepsy Centers (NAEC) epilepsy program**, a designation given to centers that provide the highest level of epilepsy care, including pharmacotherapy, epilepsy surgery, neuromodulation and diet therapy.

The Division is also a designated Parent Project Muscular Dystrophy Center, a Muscular Dystrophy Association care center, a Hereditary Neuropathy Foundation Charcot-Marie-Tooth (CMT) center of excellence and a Spinal Muscular Atrophy (SMA) care center of excellence. Added to these programs are the Division's Brain Tumor, Tuberous Sclerosis, Neurometabolic, Spasticity, Headache, Tourette Syndrome and Spina Bifida clinics.

Research

Arkansas Children's Research Institute

Advances in pediatric medicine begin with the thought of a future in which all children can grow up to be healthy adults. **Arkansas Children's Research Institute (ACRI)** was established to provide UAMS faculty and scientists with a research environment on the Arkansas Children's Hospital campus. Officially opening in 1992, ACRI now has more than **120 pediatric researchers** with expertise and experience that span the breadth of medical disciplines. Their research capability is diverse, ranging from basic science to clinical and community-based research.

ACRI houses excellent research programs in **infectious diseases, endocrinology, osteogenesis, asthma and allergic disorders, children's nutrition, pain, health promotion, injury prevention, birth defects prevention, pediatric pharmacology, and population health**. While most ACRI researchers are from the Department of Pediatrics, others are from UAMS clinical and basic science departments such as **Otolaryngology, Psychiatry, Surgery, Biochemistry and Molecular Biology, Microbiology and Immunology, and Pharmacology and Toxicology**, providing opportunities for strong collaborative teams and grant applications.

In fiscal year 2022, ACRI researchers received over \$30 million in grants and contracts from federal, state, and private agencies, industry sponsors, and philanthropic donations. Approximately **\$23 million was from the National Institutes of Health**.

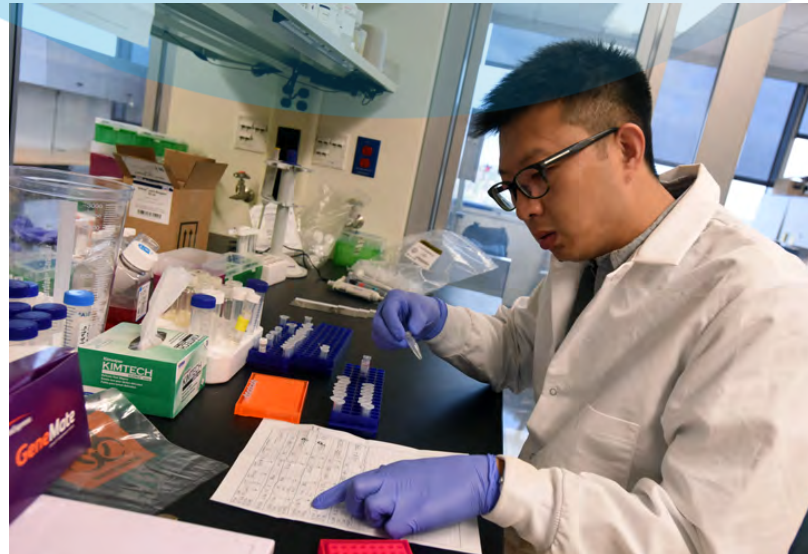

ACRI research awards contributed a **ranking of #25 for the Department of Pediatrics amongst all pediatric departments/pediatric research institutes in NIH funding**.

The four-story Research Institute building has more than **196,000 square-feet** of research space and houses ACRI administrative and researcher offices, laboratories, animal facilities and conference space.

Operations, facilities, and safety teams maintain ACRI's scientific resources and assets to ease study conduct and institutional preparedness.



Research



Modern and ample laboratory space throughout the research campus is easily adapted to meet the needs of researchers and their staff.

The ACRI Vivarium, a 35,000 square-foot, AAALAC-accredited facility, houses all animals used in research and provides procedure rooms, pathogen-free containment units, wet laboratories and surgical suites.

On-site veterinarians are responsible for veterinary care through rounds and on-call availability.

Animal research staff provide consultation to investigators and staff concerning animal care and housing, surgical procedures, and Institutional Animal Care and Use Committee protocols.



Many **researchers conduct their clinical trials** at ACRI's Pediatric Clinical Research Unit at ACH's main hospital building. Available 24 hours a day, 7 days a week, **the 4,000 square-foot facility** includes semi-private and private beds for high-quality clinical pediatric research.

A staff of qualified nurse research coordinators assists with pre-site visits, Institutional Review Board submissions, and day-to-day operations of clinical studies throughout the ACH campus.

The **1,035 square-foot, on-site Research Pharmacy** supports inpatient and outpatient trials and oversees the formulating, dispensing, accounting, blinding and storing of drugs and the documentation of these activities.



Community-based **researchers conduct projects in fields such as asthma, injury prevention, nutrition, and health promotion** to improve health outcomes for children in the state's rural and urban communities.

ACRI holds two Phase II NIH Centers of Biological Research Excellence (COBRE) awards: the Center for Childhood Obesity Prevention and the Center for Translational Pediatric Research. Both centers create rich environments for young faculty identified as the next generation of excellence in research.

Research



ACRI acknowledges the potential and importance of its researchers' work through competitive intramural grant programs to assist and encourage researchers of all levels of experience awarding \$650,000 to \$800,000 annually.

In addition to UAMS, **ACRI researchers collaborate with other university entities** (UA-Fayetteville, UA-Little Rock, and UA Clinton School of Public Service), the VA's Central Arkansas Veterans Healthcare System and the FDA's National Center for Toxicological Research.

The Arkansas Children's Innovation Center provides training and mentoring to physicians, clinicians and scientists on moving innovations to market.

ACRI's research support staff act as facilitators to ease the administrative burden of sponsored research and provide an array of unique services outside the general area of research administration.

ACRI's administrative staff supports researchers throughout the grant process providing pre- and post-award assistance including proposal development support, study auditing to ensure compliance and determining the accuracy of proposal budgets.



Research

Arkansas Children's Nutrition Center

The **Arkansas Children's Nutrition Center (ACNC)** is a **national Human Nutrition Research Center (NHNC)** established in partnership between ACH and the **United States Department of Agriculture-Agricultural Research Service (USDAARS)**.

The mission of the ACNC is to conduct cutting-edge research to understand how maternal-child nutrition and physical activity optimize health and development.

ACNC is one of only six NHNCs funded through the USDAARS and **one of two centers** focused on pediatric and maternal nutrition and metabolic health in the United States.

With approximately **54,000-square-feet of shared research space and nine core research facilities** designed for its team of more than 75 scientists and support staff, the ACNC provides clinical research facilities and innovative research laboratories to meet its mission.

As one of the only USDA-funded centers examining maternal and pediatric physical activity, the facility is well equipped for long-term and short-term physical activity and exercise research in an increasingly relevant population.

In its nearly 30 years in operation, the **ACNC has earned a robust record of supporting several large, longitudinal cohorts and randomized control trials** from design to +12-year follow-up.

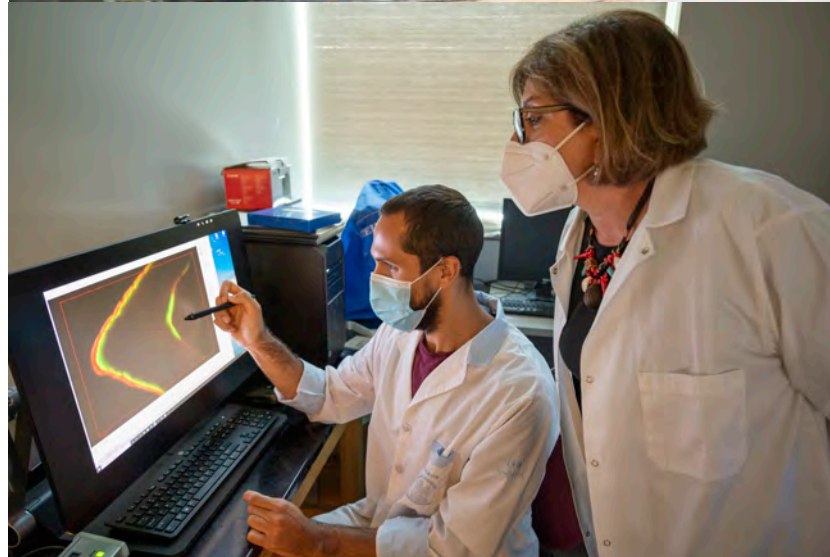

Research

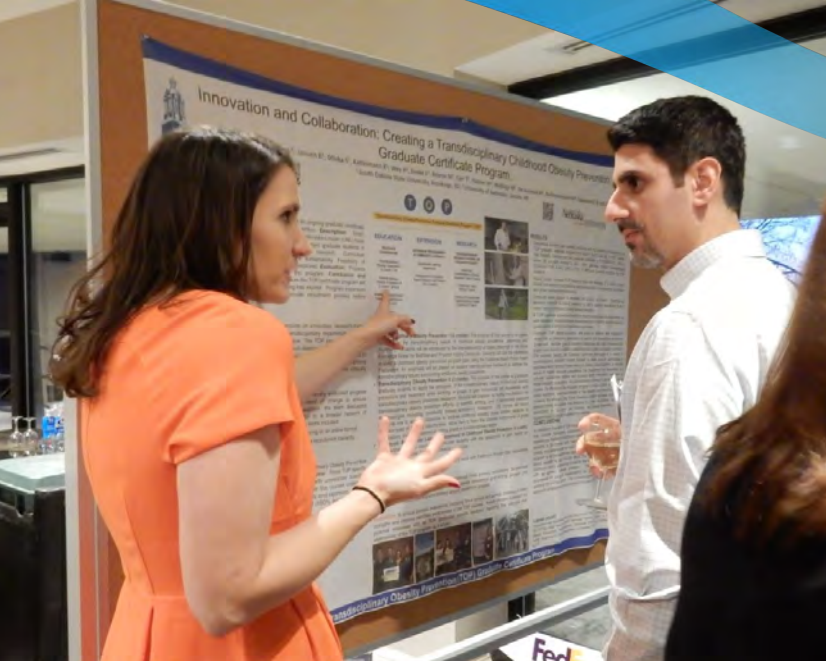

A perfectly positioned hub for nutrition collaboration with affiliated research faculty in the UAMS system and externally – the **ACNC builds interdisciplinary teams to enhance basic and clinical research programs** and foster translation to sound dietary guidance that impacts maternal and child health.

From bioimaging and microscopy to data analytics and visualization to novel animal models and telemetry - **the ACNC's repertoire keeps expanding. Its nine core research facilities are outfitted with the latest instruments and many employ full-time technicians.**

Our laboratories reflect the diverse interests and expertise of our scientists. Together, the ACNC research labs allow us to pursue questions important to maternal/child health from a "holistic" viewpoint that considers all the body's systems alongside environmental and family variables.

Since its 1994 inception, the ACNC has become a premier maternal-child health and early childhood development research venue, with strong and established collaborative ties with the USDA, NIH, private sector foundations, USAID and other stakeholder institutions.

Part of a supportive research community with a high patient volume in an academic medical center, the **ACNC provides seamless accessibility to champion translational research.**

Our significant cores and facilities support the **multidisciplinary, team-centered collaborative environment** that makes ACNC scientists so effective. This enables us to examine biology at a very fundamental level—from tissues, cells and DNA to studies of hundreds of molecules normally found in blood—and to also consider science at the "whole body" level, where we measure clinical outcomes such as body composition, diet and physical fitness.



Research

UAMS Division of Research and Innovation

Research is woven into every fiber of UAMS' academic and clinical endeavors, making the **support and collaboration** of the institution's investigators and scientists a defining trait of the university.

The Division of Research and Innovation at UAMS uses a multidisciplinary approach to support faculty and successfully secure extramural and intramural research funding. **The Office oversees research funding of more than \$150 million** across UAMS and UAMS researchers working in the Arkansas Children's Research Institute and Central Arkansas Veterans Healthcare System. The Office of Research and Innovation is comprised of several labs, research cores and offices that support, facilitate, protect and streamline the administrative processes associated with research.

Translational Research Institute (TRI) was established in 2009 under the National Center for Advancing Translational Sciences' (NCATS) Clinical and Translational Science Award (CTSA); the Institute was formed to provide infrastructure support to ensure the rapid translation of UAMS' research discoveries to the community, navigate barriers to translational research and invest in promising new scientists. Researchers have access to a variety of services and resources, including consultations, specialized training and subject study recruitment, to name a few. The Institute supports all researchers within the UAMS System and the affiliated sites, Arkansas Children's Hospital and the Central Arkansas Veterans Healthcare System.

BioVentures was formed to accelerate the translation of the latest research and discovery innovations for launch to the global life sciences market. From intellectual property management and technology commercialization to the development of health sciences startups, entrepreneurial commercial partnerships are formed to advance UAMS' science and contribute to the health of patient populations and the economic growth and development of Arkansas. UAMS offers numerous training programs, including **fastPace**, a four-week biomedical commercialization course designed to help researchers and clinicians learn the basics to bridge the bench-to-business journey.

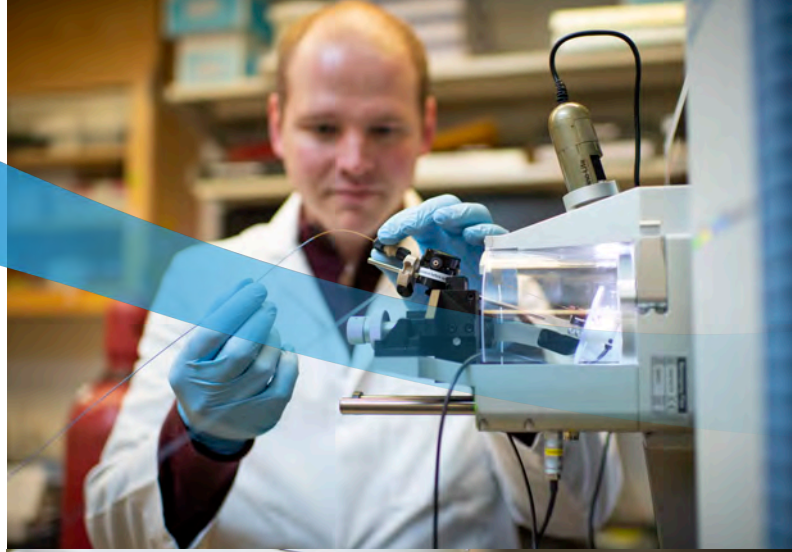

BioVentures by the numbers:

- 37 invention disclosures (FY20)
- 25 new patent applications, and five U.S. patents granted (FY20)
- Currently 26 BioVentures spin-off companies of 42 total are in operation today



Research



The **Institutional Animal Care and Use Committee (IACUC)** monitors and protects the welfare of animal subjects involved in biomedical research.

- 300 active protocols from more than 100 principal investigators and 24 divisions
- IACUC reviews an average of 10 new protocols each month
- Approximately 15 annual protocol reviews conducted monthly or 180 each year
- 25 addendum requests reviewed per month or 300 per year
- IACUC visits the ACHRI/UAMS campuses (i.e., five vivariums in four buildings; 83 labs in eight buildings) to discuss research projects, ensure housing, husbandry and procedure areas are maintained, verify that required documentation is up-to-date, and check for personnel safety compliance

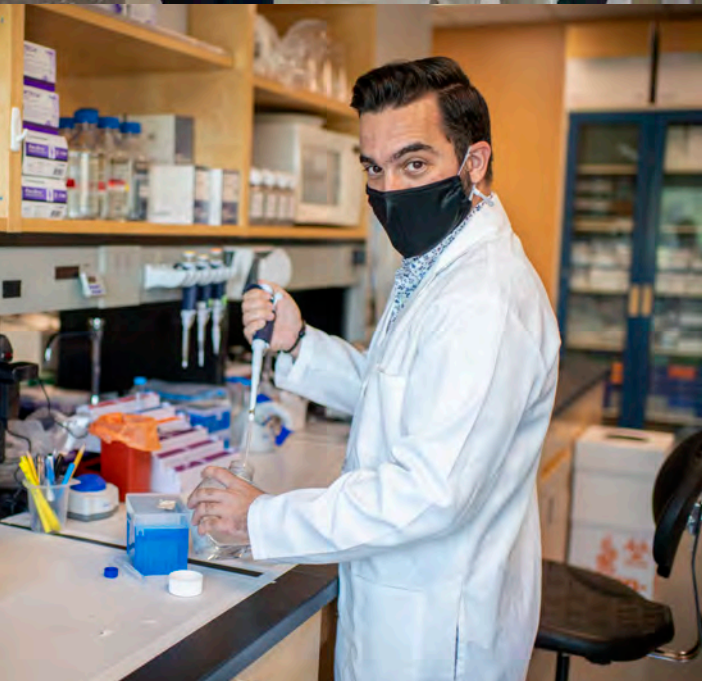

The **Institutional Review Board** was formed to protect the rights and welfare of subjects involved in the human research it oversees.

- Reviewed a total of 363 new human research projects in FY20 (full board, expedited and exempt statuses)
- 1,318 human subject protocols were open during FY20
- Mean days for PIs to receive full Board approval decreased by 20% since 2016 (CLARA submission through IRB approval, including pre-review of budget, etc.)
- 17% increase in the number of modifications submitted since 2016

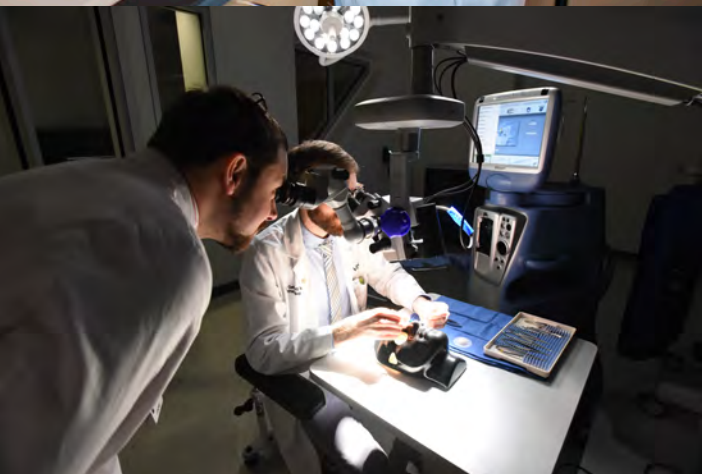

The **Office of Research Regulatory Affairs (ORRA)** is a resource that provides deep knowledge and regulatory support to the UAMS research community.

- Currently has more than 30 active IND/IDE studies, with an additional 12 in process of FDA submission or study start-up
- Submits approximately 80-100 FDA reports annually, including initial submissions, project modifications and safety reporting
- Receives 150-200 requests annually to review protocols for IND/IDE determination and/or assistance with protocol writing and project submissions
- Conducts 75-100 monitoring visits annually at UAMS, ACH, ACRI, the University of Arkansas Little Rock (UALR) and various partner sites across the state
- Oversight of an average of 70 records/year on ClinicalTrials.gov

Research

Office of Research and Sponsored Programs (ORSP) provides support for UAMS faculty in the acquisition, performance and administration of projects and programs funded by extramural sources.

- Processed more than 600 proposals, including 350 to the NIH (FY2019)
- Processed more than 300 awards totaling \$81,079,637 (FY2019)
 - 19% increase in the number of new UAMS grant awards since 2016
- Processed 160 federal grant sub-awards, \$9 million (FY2019)



Office of Sponsored Programs Administrative Network (OSPAN) provides administrative support to sponsored programs and their stakeholders.

- 18% increase in the number of new UAMS grant proposals since 2016

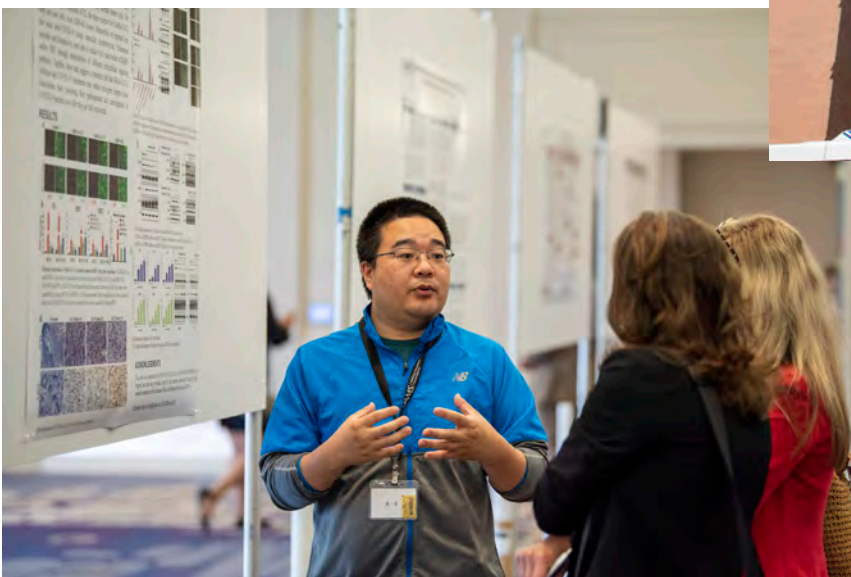

Science Communication Group (SciCom) is a scientific editing resource available to UAMS investigators at no cost.

- Edited 104 grants and 42 manuscripts (2019)
- Experienced staff of editors with research experience and certified by the Board of Editors in the Life Sciences
- Manages the submission of large-multicomponent applications: COBREs, INBRE, P01s
- A certified research administrator coordinates large submissions and mentors junior investigators



Faculty Support and Development

Center for Faculty Excellence

The goal of the faculty center is to support our faculty during all phases of your career. Our mission is to prepare recognized leaders who excel as clinicians, researchers, and educators in Arkansas, nationally and internationally. Our focus is on creating a positive, supportive and diverse work environment in which faculty can excel.

The UAMS Department of Pediatrics is dedicated to the professional growth and success of all our faculty. Our mentoring program is intended to support new faculty members adjusting to their new environment. Whether adjusting to academe itself, settling into your first year at UAMS, or simply settling into Arkansas, assistance from a well-respected mentor can be an invaluable supplement to guide and orient new faculty.

Faculty have the opportunity to partner with mentors to explore activities, topics and mutual interests, including grant proposals, establishing a publication record, conference involvement, research group organization, creating a teaching portfolio, publication of education-related papers, classroom management, preparing CVs, defining tenure and promotion expectations, and exploring departmental resources and/or college associations, teams, or interest groups.

Promotion and tenure is a way to recognize and reward UAMS faculty members for their accomplishments and their contributions in clinical, teaching, scholarship, and leadership service. Our department has a team of dedicated reviewers to help guide and prepare exemplary packets for promotion advancement.

We also offer resources to encourage and support faculty development and excellence with regular seminar series and our executive coaching program to develop skills in leadership, professional development and health.



For more than 25 years the Department of Pediatrics has conducted a highly successful, formal Faculty Mentoring Program focused on guiding junior faculty to achieve timely Promotion/Tenure while supporting their well-being.

All assistant professors have a unique, personalized 3-member Mentoring Committee formed for them which meets biannually to guide academic productivity and nurture work-life balance. **In 2018 our established, successful mentoring program received national recognition** when it was published in PEDIATRICS as “An Adaptable Pediatrics Faculty Mentoring Model”.



Diversity and Health Equity

UAMS is dedicated to diversity, equity and inclusion across all our campuses and was named a 2022 Top Performer in the Human Rights Campaign's Healthcare Equality Index.

Inclusive Excellence at UAMS is the recognition that the institution's success hinges on how well it values, engages, and includes diverse faculty, staff, trainees, students, patients and the community.



A highly diverse UAMS Department of Pediatrics will improve the health and well-being of the children and families in Arkansas and the nation through inclusive and measurable efforts to achieve health equity in all mission areas.

UAMS achieves equity and inclusivity through superb external and internal partnerships and engagement in all ways community can be defined..

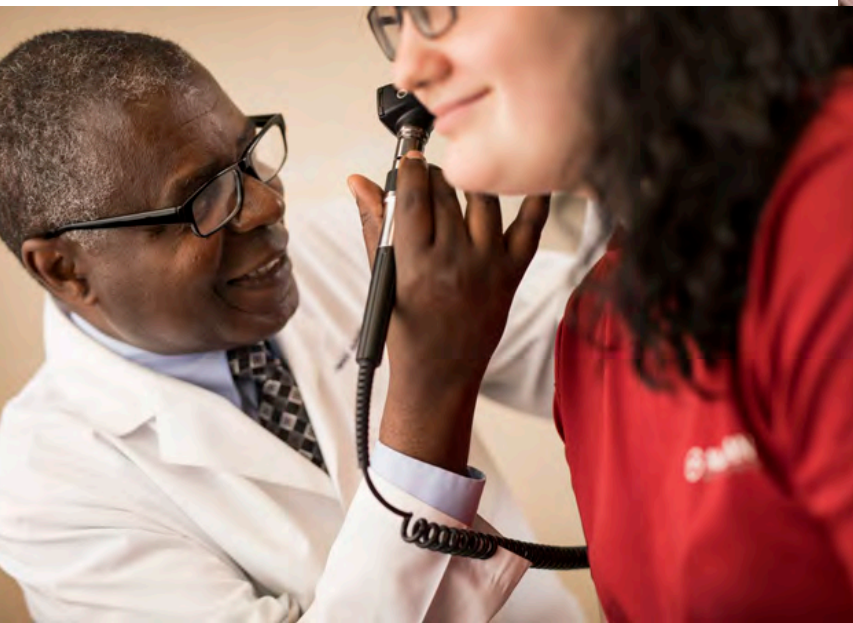

Through collaboration and partnership with our internal and external communities, nonprofits, philanthropy, education, clinical care and research stakeholders, we advance diversity and enhance health equity.



The department has a dedicated Vice - Chair of Diversity and Health Equity, Dr. Eduardo Ochoa, Jr., who serves as our Chief Diversity Officer.



Faculty Group Benefits



UAMS and the Department of Pediatrics highly value work/life balance with excellent benefits, some of which include:

Paid annual leave:

- Up to **22.5** vacation
- Up to **12** sick days
- **11** holidays (including birthday)
- Education, Jury Service, and Military Leave

Medical and Dental Insurance Premiums

covered for faculty, with appointments (percent of time) at 75% or greater, and their family for the medical Classic or Health Savings plans and the dental plan.

Exceptional **retirement** plans, with contributions matching up to 10% per pay period (within IRS limits).

Tuition discounts at any University of Arkansas campus, including eVersity, for employees, spouses and eligible dependents.

UAMS employees are eligible to participate in the **Public Service Loan Forgiveness** (PSLF) program.

Relocation Benefits, Educational Funds, Paid Malpractice and DEA certification, and many merchant discounts.

About Arkansas Children's

The UAMS Department of Pediatrics and its residents make their home at Arkansas Children's. A private nonprofit, Arkansas Children's boasts an internationally renowned reputation for medical breakthroughs and intensive treatments, unique surgical procedures and forward-thinking research and is committed to providing every child with access to the best care available, regardless of location or resources.

Arkansas Children's includes Arkansas Children's Care Network, Arkansas Children's Hospital, Arkansas Children's Northwest, Arkansas Children's Research Institute and Arkansas Children's Foundation. Arkansas Children's also blankets the state with outreach programs, telemedicine, mobile health and school-based health solutions.



Arkansas Children's Hospital (ACH), located in Little Rock, provides pediatric sub-specialty services designed to address needs through every stage of a child's life.



- Arkansas Children's Hospital campus spans 36 city blocks and houses 336 licensed beds
- Arkansas' only pediatric Level 1 Trauma Center
- Neonatal Intensive Care Unit (NICU) with 98 beds, and an additional 64 beds on the UAMS campus.
- Pediatric Intensive Care Unit (PICU) with 26 beds
- Cardiovascular Intensive Care Unit (CVICU) with 31 beds
- Staff includes approximately 500 physicians and 4400+ employees



Arkansas Children's is also home to the Angel One medical transport program, which performs more than 2,100 transports per year, with 1,200 by helicopter. Our two state-of-the-art helicopters enable Arkansas Children's to provide safe and timely assistance to children all over our great state and neighboring areas.

About Arkansas Children's Northwest



Opened in 2018, Arkansas Children's Northwest (ACNW) is the region's only pediatric children's hospital and was designed to provide exceptional care for children in the region. It features:

- Currently 30 in-patient beds with room to expand to 96
- 42 clinic exam rooms
- Five operating rooms
- Infusion clinic
- MRI, CT, ultrasound, X-ray imaging
- PT, OT and speech therapy clinics

The **233,613-square-foot hospital** covers every medical sub-specialty and features exceptional amenities that drive the best outcomes for patients and families. In addition to **on-site anesthesia, cardiology, emergency care, endocrinology, general surgery, gastroenterology, ENT, hematology/oncology, neurosciences, pulmonary, orthopaedics and sports medicine and urology care**, physicians from more than 20 specialties visit ACNW on a weekly, monthly or quarterly basis.

In addition to clinical care, ACNW provides access to leading-edge research programs and clinical trials through the Arkansas Children's Research Institute.

The clinical trials for children at ACNW cover various health needs ranging from cancer, vascular anomalies, hemophilia and bleeding disorders to diabetes, neurosciences and pulmonary studies.



About UAMS

Located 2 miles west of Arkansas Children's Hospital, the **University of Arkansas for Medical Sciences (UAMS)** is the state's leading tertiary academic health center. UAMS includes five colleges and a graduate school, eight regional centers and seven institutes of excellence. With its intersection of education, research and clinical programs, UAMS offers a unique capacity to lead health care improvement in Arkansas.



UAMS has experienced a period of growth with **more than \$425 million invested to construct or expand facilities**, transforming the campus and increasing its capacity for patient care, research and education. The completed projects include a 10-level, \$200 million hospital building that incorporates the latest medical technology and serves as the only adult Level 1 Trauma Center in the state. Among UAMS' latest projects are The Orthopaedic and Spine Hospital at UAMS, an \$85 million, 158,000-square-foot facility complete with patient rooms and 12 operating suites, and a new Radiation Oncology Center, which will house the state's first Proton Center, a partnership between UAMS, Arkansas Children's, Baptist Health and Proton International.

The state's largest public employer, UAMS, has a workforce of more than 11,000 people, including 1200 physicians who provide care at locations across the state.

In clinical care, UAMS has been featured for multiple years as one of "America's Best Hospitals" by U.S. News & World Report and has been listed as one of the 100 "Hospital of Choice" award winners by the American Alliance of Healthcare Providers.

UAMS ranks in the top 10% of hospitals nationwide for cranial neurosurgery, according to Healthgrades, a resource that connects consumers, physicians and health systems. Healthgrades awarded UAMS a 2022 Cranial Neurosurgery Excellence Award, recognizing the hospital's superior clinical outcomes in brain surgery.



About UAMS

UAMS is home to Arkansas' only center for kidney and liver transplants, and its survival rates for both procedures exceed the national average.

Stroke care is another area in which UAMS excels. UAMS Medical Center was the first health care provider in the state to be certified by The Joint Commission as a Comprehensive Stroke Center. The designation is given to hospitals that show the ability to receive and treat the most complex stroke cases.

UAMS is also **the only hospital in Arkansas, and one of 15 nationwide, to be designated as a da Vinci Observation Epicenter in robotic surgery.** Intuitive Surgical, the company that makes the da Vinci Surgical System, established the epicenters to provide surgeons new to the technology with an opportunity to observe and consult with skilled practitioners. UAMS is a national leader in robotic surgery, with 16 certified robotic surgeons across nine specialties.

UAMS has a unique capacity for translational research — speeding the rate at which research can inform clinical care and health improvement. The university's Translational Research Institute leads this mission by fostering community partnerships to help guide the development of important research projects.

The Winthrop P. Rockefeller Cancer Institute is the only academic cancer treatment and research facility in Arkansas. The Institute provides a comfortable patient environment and encourages collaboration among physicians, scientists and other health care professionals.

UAMS is also a leader in brain and spine health. The Jackson T. Stephens Spine & Neurosciences Institute is the first facility in Arkansas to focus on advancing research, education and clinical care for disorders of the brain, spine and nervous system.

UAMS is dedicated to providing the best care for patients of all ages, and the Donald W. Reynolds Institute on Aging strives to meet the needs of older adults. Its clinical program provides superb patient care while also serving as a laboratory for education and research.

The Harvey & Bernice Jones Eye Institute provides treatment for a variety of ocular conditions and illnesses. The Institute's ophthalmology residency program, the only one in the state, trains doctors and technicians to become skilled ophthalmic practitioners..

At the Psychiatric Research Institute, UAMS works to improve the lives of Arkansans through the treatment and study of mental illness. The staff has the experience needed to treat patients of all ages, no matter what challenges they face.



About UAMS

UAMS has also embraced digital health services as it pursues its goal of eliminating health disparities in Arkansas and beyond. The Institute for Digital Health & Innovation delivers care in a wide range of specialties through technology such as smartphones and personal computers, reducing health costs and improving patient access.

With five colleges — the College of Medicine, College of Nursing, College of Pharmacy, College of Health Professions and the Fay W. Boozman College of Public Health — and a graduate school, UAMS is committed to educating the health care professionals and scientists of tomorrow.

UAMS continues to grow its research programs, with funding in fiscal year 2021 increasing 12.2% over the previous year. Additionally, UAMS researchers are well respected in their fields, with more than 50 current and retired faculty members listed among the top 2% of influential researchers, according to a 2020 study by Stanford University.



UAMS is the official Orthopaedics and Sports Medicine provider for the University of Arkansas Razorbacks athletics, offering comprehensive care to hundreds of student-athletes and daily medical coverage for 19 sports programs. UAMS also provides orthopaedic and sports medicine care to athletes at many high schools, colleges and universities throughout the state.

Services provided by UAMS extend well beyond the Little Rock campus. UAMS founded eight regional centers to help address the shortage and uneven distribution of primary care physicians in Arkansas. Those centers offer care to underserved areas of the state, provide training for future medical professionals and operate a network of pipeline programs to encourage high school students to pursue health careers. With regional campuses located in Batesville, Jonesboro, Fayetteville, Fort Smith, Helena-West Helena, Magnolia, Pine Bluff and Texarkana, with another one planned in El Dorado, UAMS is committed to improving health care throughout Arkansas.

About Little Rock

Where the Ouachita Mountains meet the Delta, you'll find the Arkansas River and the capital city of The Natural State, Little Rock. With a population of approximately 200,000, Little Rock is large enough to be culturally diverse and small enough to encourage a feeling of community among its citizens. Little Rock is full of modern innovation tempered by rich history.



About Little Rock

Cost of living in Little Rock in 2022 according to Numbeo.com, an independent cost of living database:

- Four-person family monthly costs: \$2,784.93 without rent
- A single person monthly costs: \$800.97 without rent
- Cost of living index in Little Rock is 39.69% lower vs. New York
- Cost of living rank 296 out of 586 cities in the world
- Little Rock has a cost-of-living index of 60.31



With arts, culture and education centers like the Little Rock Zoo, the Museum of Discovery, the Clinton Presidential Library, the Robinson Center (pictured, left) and the Arkansas Museum of Fine Arts, Little Rock is a great place to educate and entertain family and guests.

Sports fans will enjoy watching baseball games at Dickey-Stephens Park, home of our minor league baseball team, the Arkansas Travelers. Little Rock has two great venues, Simmons Bank Arena and Riverfront Amphitheater, which offer music lovers a chance to see their favorite performers in concert.



About Little Rock



The city possesses breathtaking natural beauty thanks to its mountains, river valleys and miles of untouched woods. Outdoor enthusiasts can enjoy abundant opportunities for hiking, biking, sailing, kayaking, paddle-boarding, camping and more.

Annual events like the Main Street Food Truck Festival, International Greek Food Festival, Central Arkansas Pride, Mosaic Templars' Juneteenth, The Irish Cultural Society of Arkansas' St. Patrick's Day Parade, the World Cheese Dip Championships and Africa Day Festival highlight the city's cultural diversity.

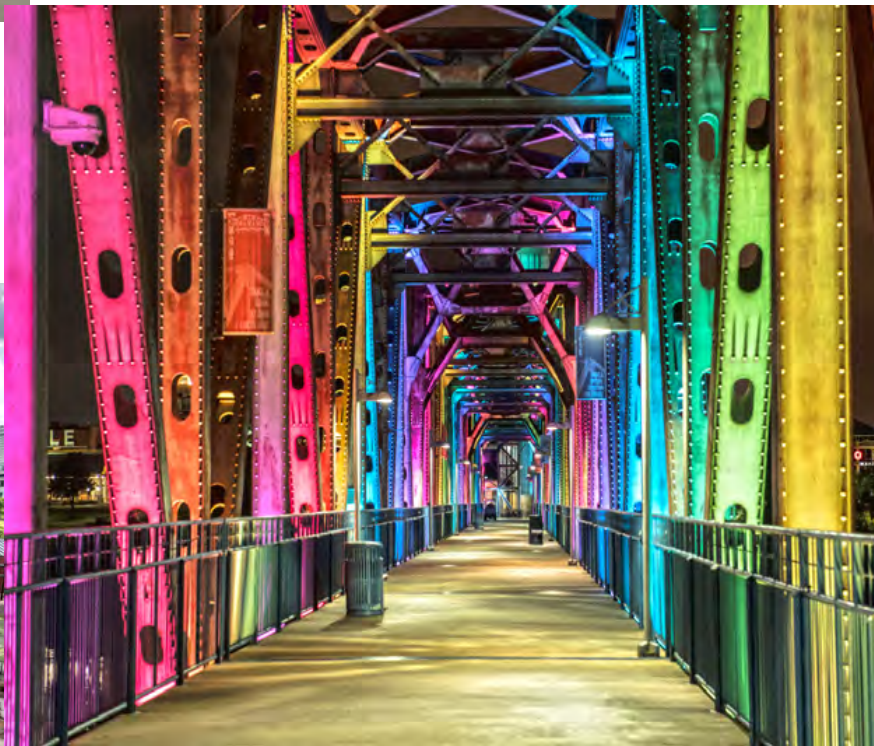

Man-made wonders such as the Big Dam Bridge and the Arkansas River Trail offer an ideal setting for a variety of outdoor activities, which help support active lifestyles.

Little Rock's more than 60 city parks provide ample access to outdoor recreation and relaxation options.

There is something for everyone in Arkansas' capital city!

About Arkansas

Known as the Natural State, Arkansas hosts an abundance of scenic vistas from lakes and rivers to the breathtaking Ozark and Ouachita Mountains, Arkansas is home to endless outdoor adventures. Our temperate climate allows you to enjoy all four seasons in the great Arkansas outdoors. There is more to discover than just natural wonders around the state. Each region has unique attractions that draw increasing crowds from across the nation..



Pinnacle Mountain State Park is minutes west of downtown Little Rock, and the mountain's summit provides hikers with a birds-eye view of the city. The hike to the top includes several overlooks, some offering views of the water portion of the Trail of Tears route. The park consists of various nature trails around the base, exceptional mountain bike trails for every level of rider and several canoe and kayak areas.



Heading east towards Tennessee is the **Arkansas Delta**. This region of the state boasts some of the region's best artists, BBQ, and Blues. You can visit sites dedicated to Johnny Cash and Ernest Hemingway. Each artist had a lasting connection to the region.



About Arkansas

Southwest Arkansas is known for its incredible hot springs and spas, lakes, a public diamond mine and the birthplace of America's 42nd President, Bill Clinton.



Petit Jean Mountain is among the most popular recreation areas in central Arkansas. Come experience the beauty from its overlooks while you hike its trails through forests and meadows, over canyons, along streams and the mountainside.



A trip to Hot Springs is a must, and if the ponies are running at Oaklawn Racing Casino Resort, stop in for a corned-beef sandwich. It's a rite of passage.



The spectacular **95-foot Cedar Falls**, Seven Hollows, and distinctive features such as Bear Cave, the Grotto, and Natural Bridge are must-sees for all.

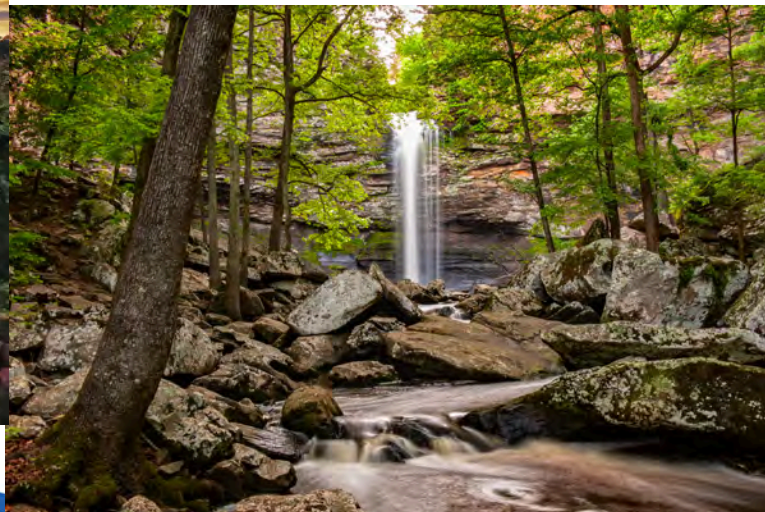

About Arkansas

Located about 2 hours Northwest of Little Rock, The Buffalo National River Park, **America's First National River**, flows freely for 135 miles. Untamed and untouched, the Buffalo remains one of the only undammed rivers remaining in the lower 48 states.



Northwest Arkansas is home to **world-class mountain biking, hiking and backpacking**. Visit the **Crystal Bridges Museum of American Art**, showcasing world-class art collections, beautiful Eureka Springs with its gorgeous historical buildings and wonderful shopping, and the state's wine-making region through the Ozark Wine Trail..



The park's 94,293 acres average more than 800,000 visitors a year across the 100 miles of hiking trails and designated trails for horseback riding. The 151 miles of scenic river is perfect for kayaking or canoeing.



It is a testament to the state's love of outdoor recreation, conservation, wellness and the diverse geographies of Central Arkansas, connecting 38 parks, six museums and 5,000+ acres of federal, state and local parkland.

